

Abflachung bei Tülle
flat when using cable gland

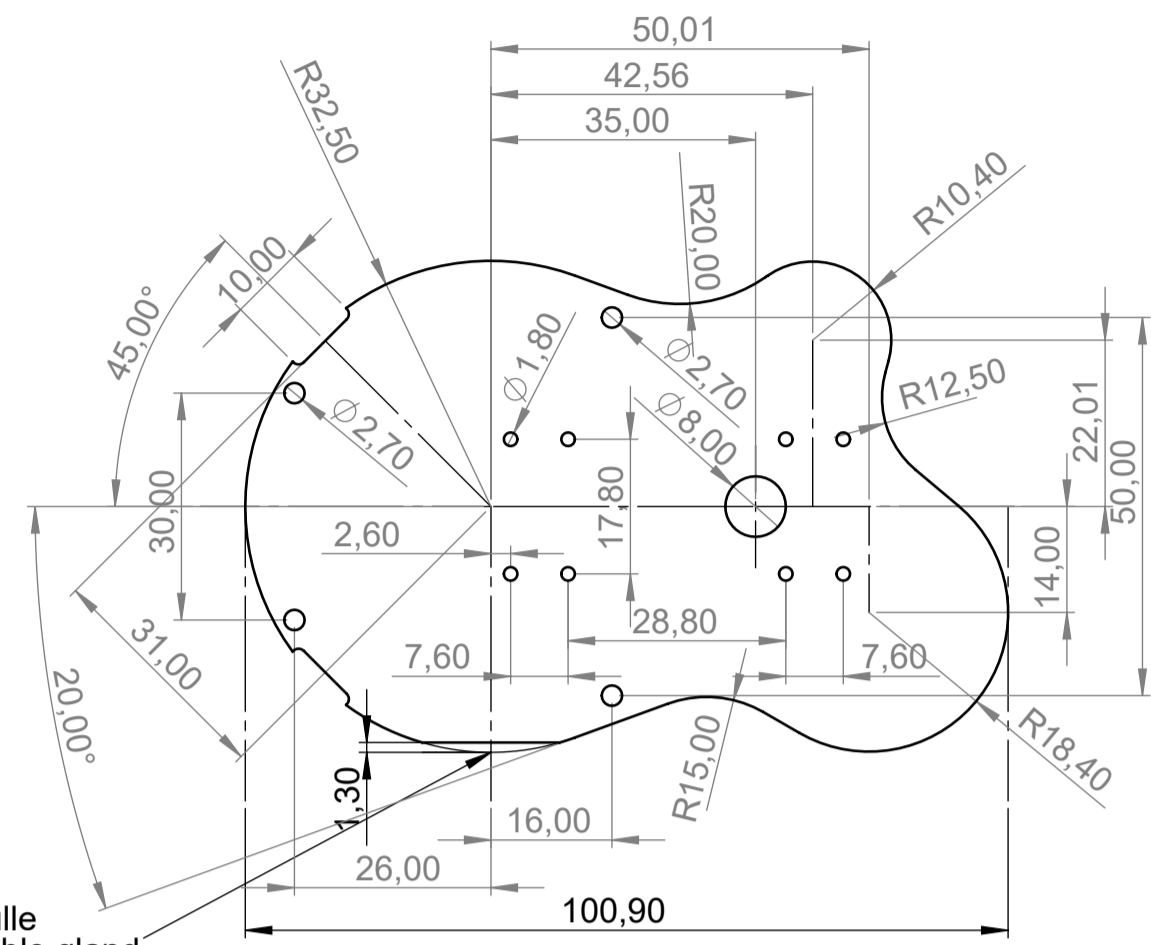

Beispielplatte mit platzierten Bohrungen für die AAA Kontaktclips
sample PCB with placed holes for the AAA battery clips

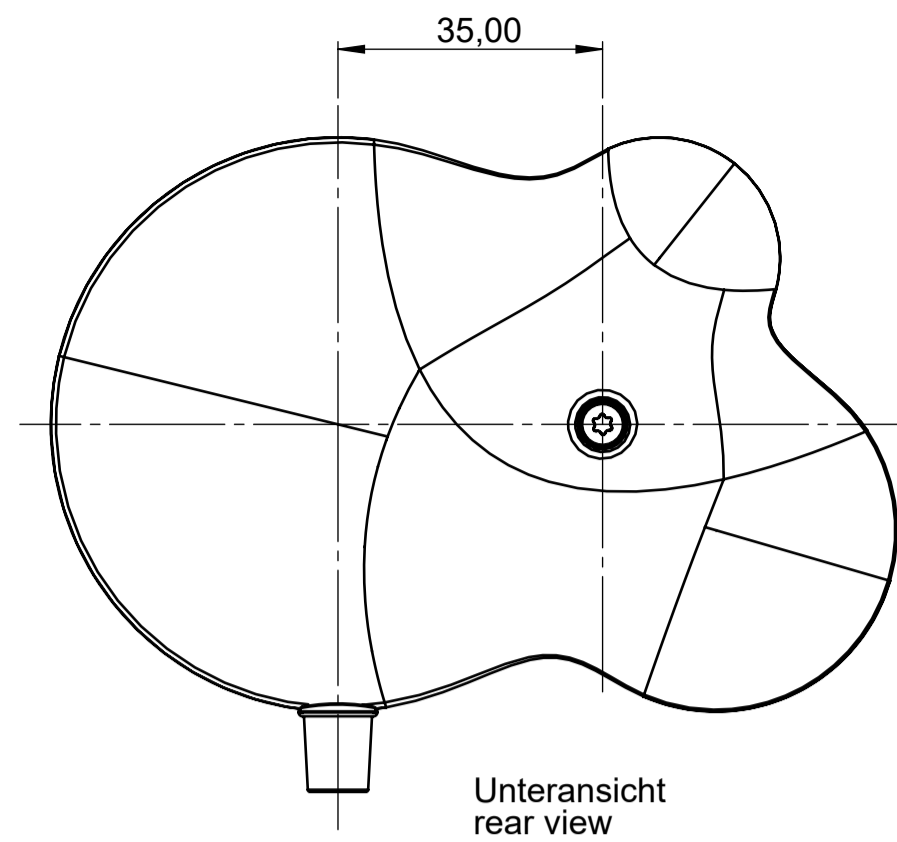

Unteransicht
rear view

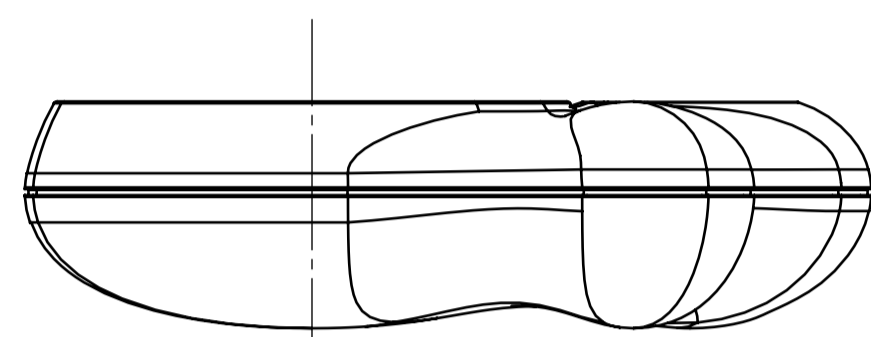

Vorderansicht
front view

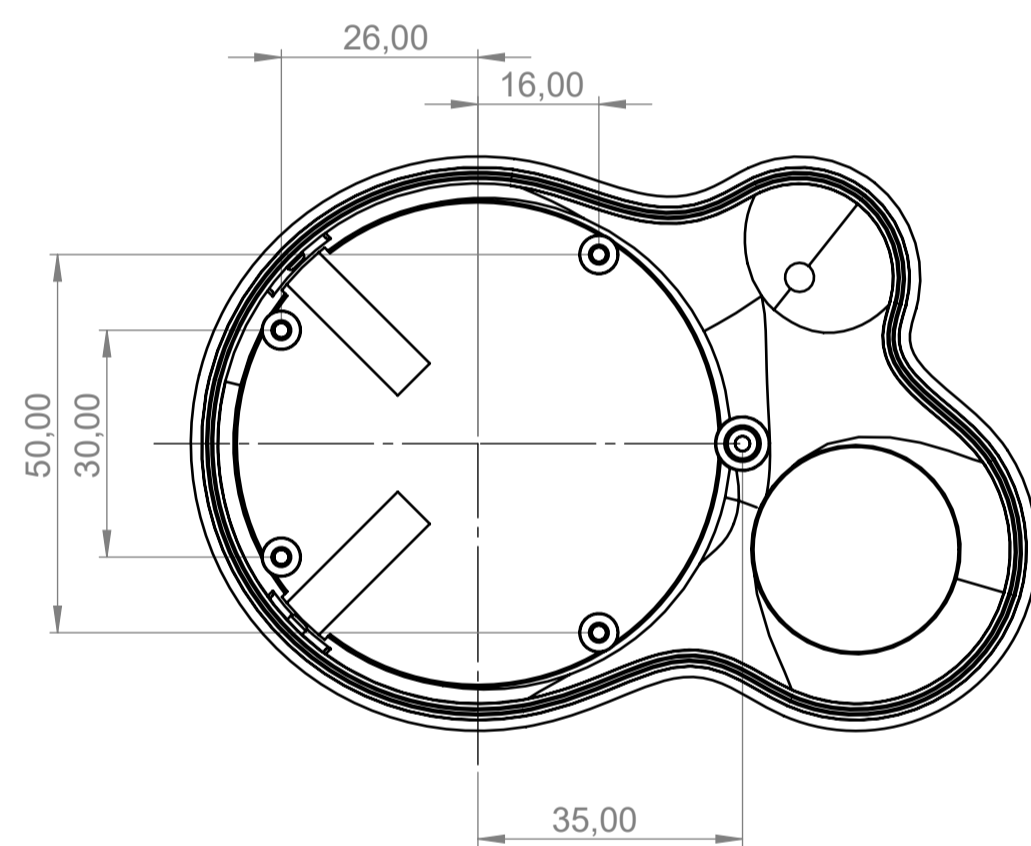
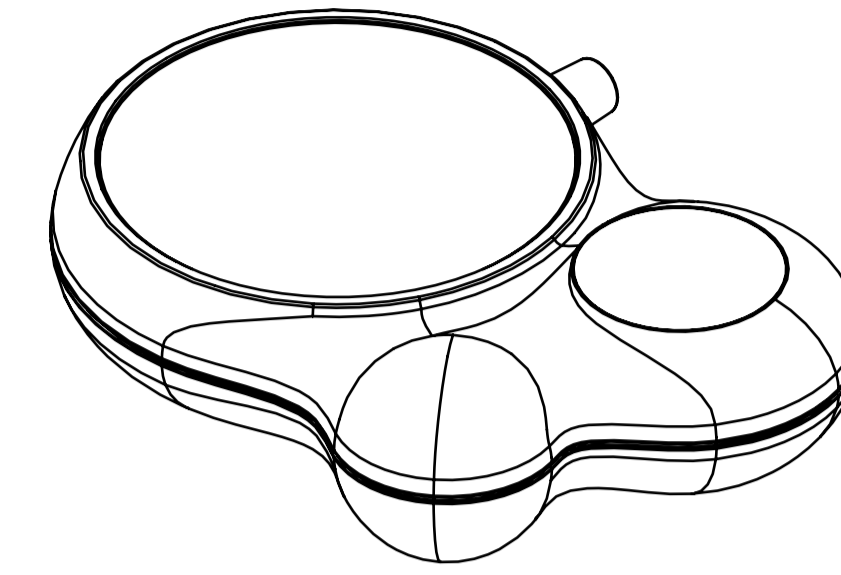

Oberteil - Innenansicht
top part - inside view

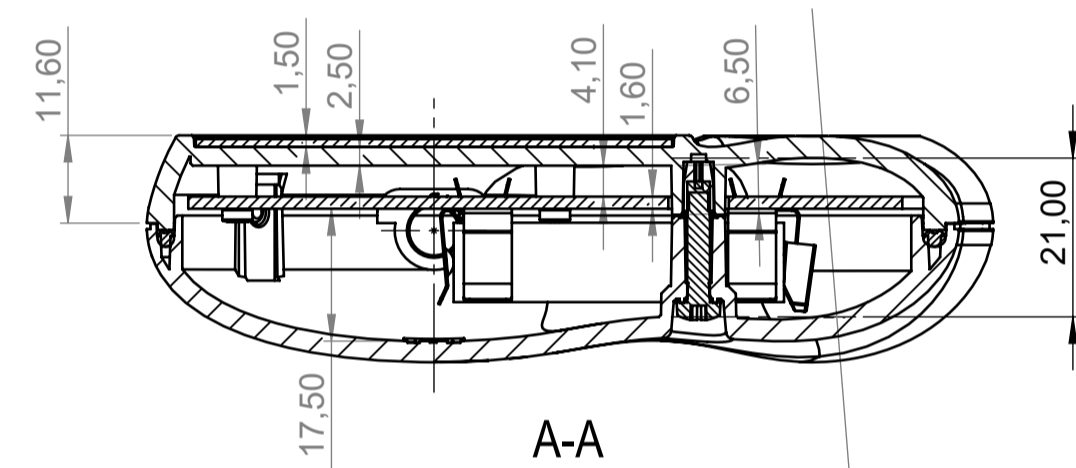

A-A

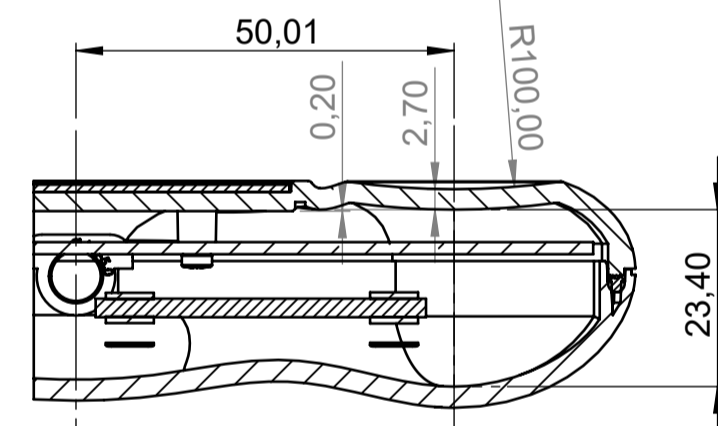

B-B

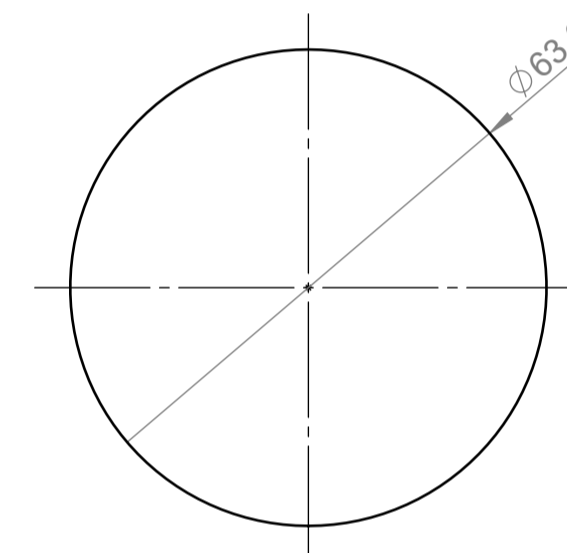

Beschneidekontur
einer Frontfolie
cut of a front foil

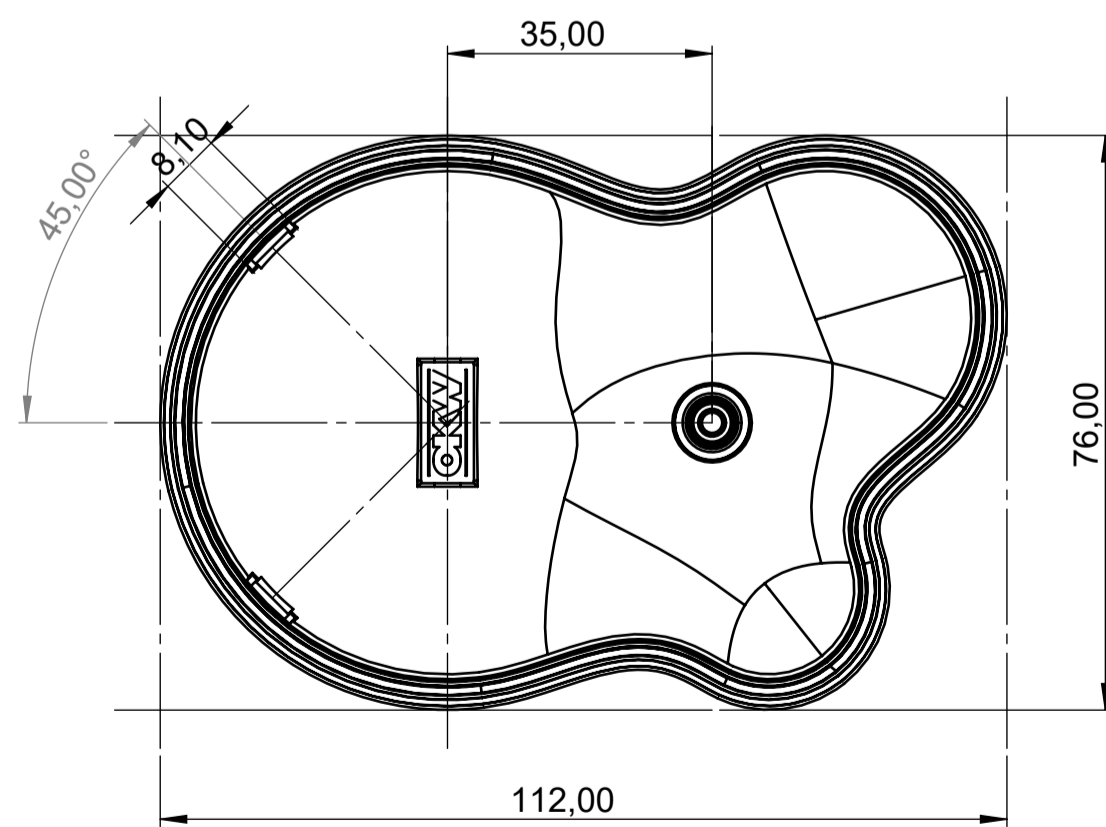

Unterteil - Innenansicht
bottom part - inside view

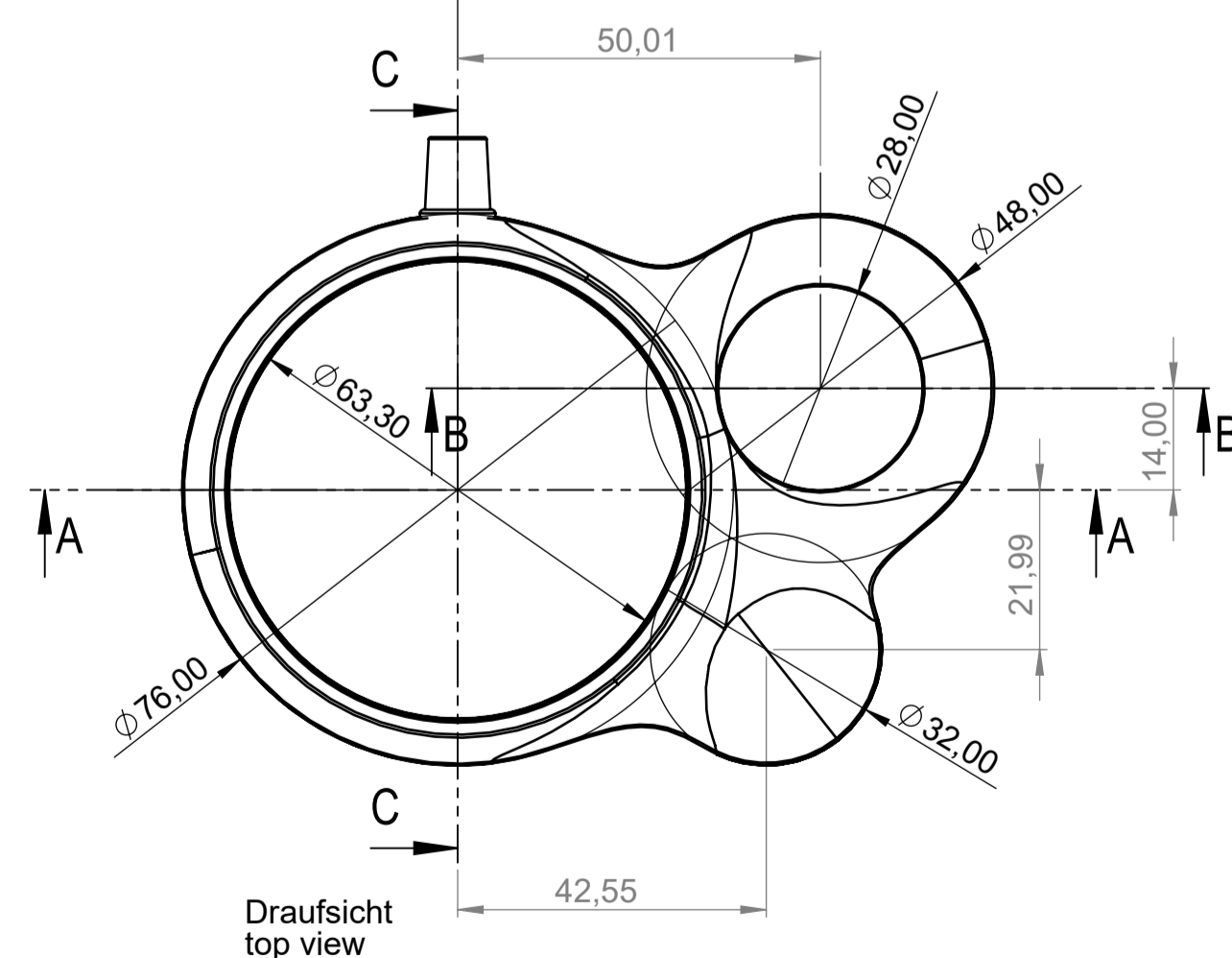

Draufsicht
top view

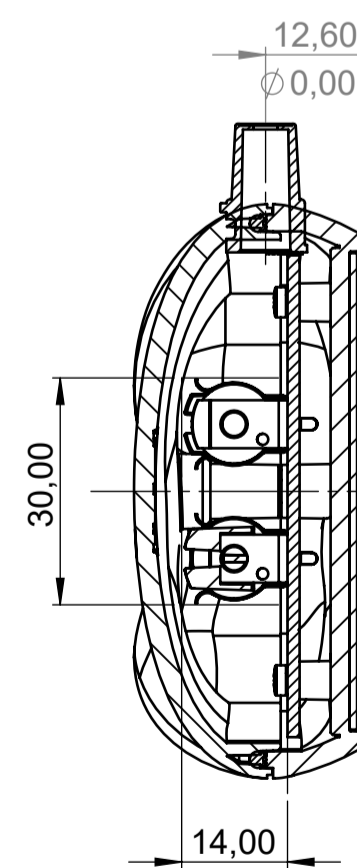

C-C

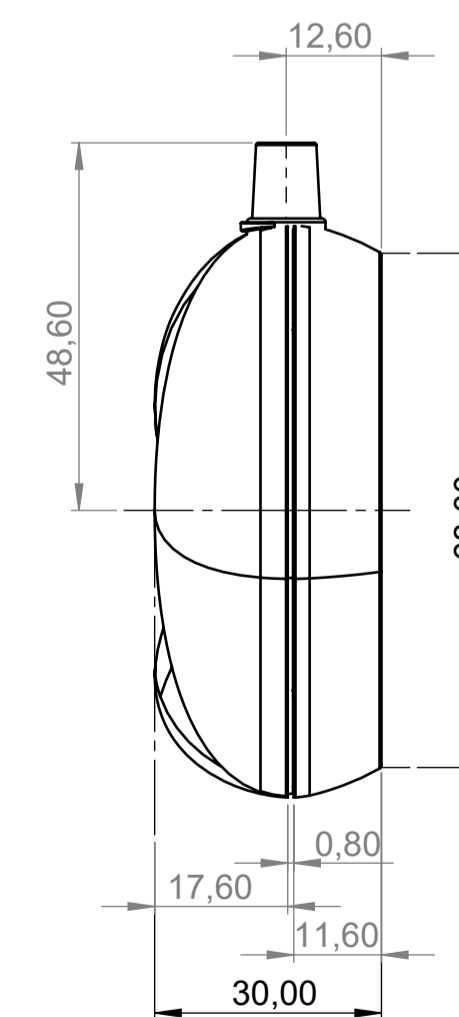

Seitenansicht links
left lateral view

Bitte die Maße an aktuellen
Teilen abnehmen.
Diese unterliegen material-
und produktionsspezifischen
Fertigungstoleranzen.

Please take the dimensions
from current parts.
These are subject to material-
and manufacturing-specific
tolerances.

Informationskopie
Copy for Information
will not be updated

Technische Änderungen vorbehalten. Interner oder Druckfehler
begünden keinen Anspruch auf Schadenersatz. Wichtige Ein-
baumängel sind direkt mit dem aktuellen Produkt abstimmen.
Subject to technical modification without prior notice. Typogra-
phical and other errors do not justify any claim for damages. All
dimensions should be verified using an actual moulded part.
Sous réserve de modifications techniques. Toute erreur ou faute
d'impression ne justifie aucune demande d'indemnisation. Nous
prions les clients de vérifier les dimensions des composants avec
les boîtiers avant le montage.

Erst. am: 22.03.2012
Erst. von: J. Both
Freig. am: 25.11.2019
Freig. von: Fahrenkopf, Jessica
Revision: 02

OKW
GEHÄUSE
SYSTEME

Toleranzen:
DIN 16901 T130

BLOB CONTROL
Assembly
B251210x

Status:
SERIENFREIGABE
Zeichnungsart:
KUNDE

This document contains proprietary information of OKW Gehäusesysteme GmbH
and is rendered subject to the conditions that the information be retained in confidence
and not be reproduced or copied and not be used or incorporated in any product.

DIN 6 Teil 2

M 1:1
Dateiname:
00013196